



<b>Sat 10/24</b>	10-12 F9		12-2 F9		2-4 F9 2-4 F10			4-5:30 F9 F10	
<b>Sat 10/31</b>	10-12 F10		12-2 2-4 F10		off				
<b>Sun 11/1</b>								2-8 groups TBD	F10
<b>Sat 11/7</b>	10-12 F10		12-2 2-4 F10						
<b>Sun 11/8</b>					2-8 groups TBD	F10		off	
<b>Sat 11/14</b>	2-4 F9		F9 4-6 F10		<b>LEAD HER TOURNAMENT 9 - 2pm</b>				
<b>Sun 11/15</b>	<b>UNITED SPORTS TOURNAMENT</b>								
<b>Sat 11/21</b>	10-12 F9		12-2 F9		2-4 F9 2-4 F10			4-5:30 F9 F10	
	<b>Shooting Star Teams ONLY</b>								

**\*Map of Proving Grounds listed below**

**\*U12/U10/U8 Groups: we will notify you of what field you will be on if there are two fields listed. On 11/1 and 11/8, we will notify you of your time slot (1.5 hour slots)**

**\*U14 Groups: we will notify you of what field or time you will play if there are two listed.**

**\*U14/16 Shooting Star Teams may have additional trainings/corner practices scheduled on weeknights at Malvern Turf**

**\*Supplemental Strength & Conditioning Training/Schedule will Tuesdays, 7:30-8:30pm for U16**

# ★ THE PROVING GROUNDS ★

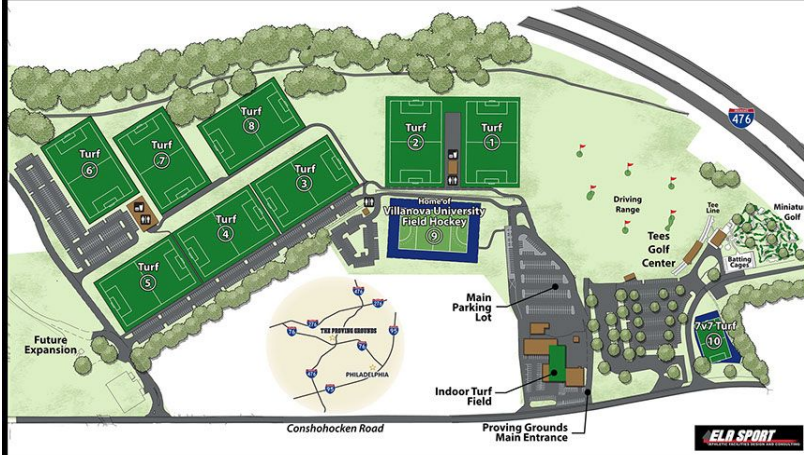

610-828-9423

TheProvingGroundsPA.com